

The Brambles,
Ball Hill, Newbury, RG20 0NY
Approx. Gross Internal Area
1907 Sq Ft - 177.16 Sq M
(Including Garage)

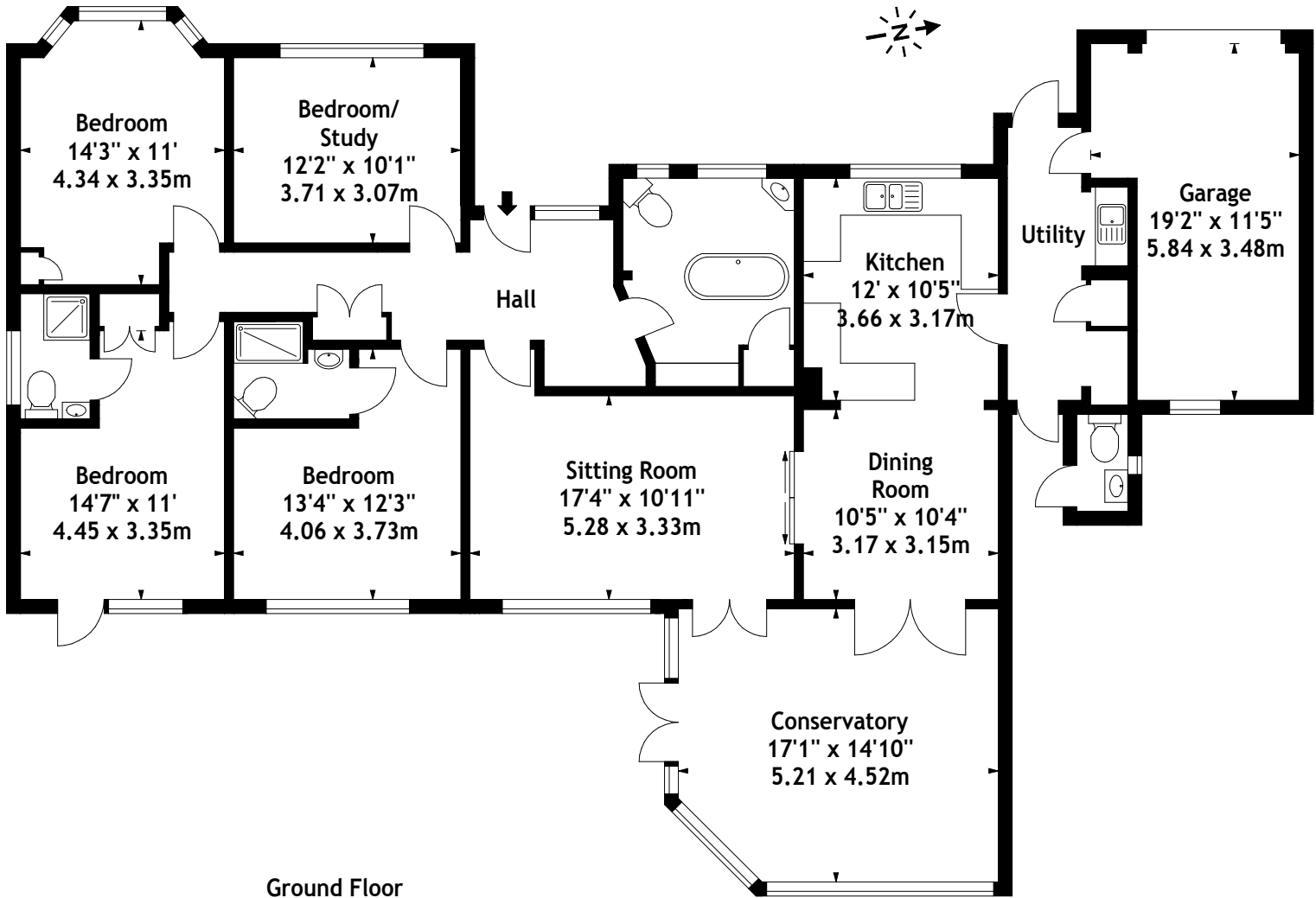

Ground Floor

Measured in accordance with RICS guidelines.
This floor plan is for illustrative purposes only and is not to scale.
Supplied Exclusively for Brunsdens in 2011
Photographs * Floorplans * EPCs
www.dighouse.net