

39 Harwood Rise, Woolton Hill, RG20 9XW

Approximate Gross Internal Area :- 90 sq m / 969 sq ft

Garage :- 13 sq m / 140 sq ft

Total :- 103 sq m / 1109 sq ft

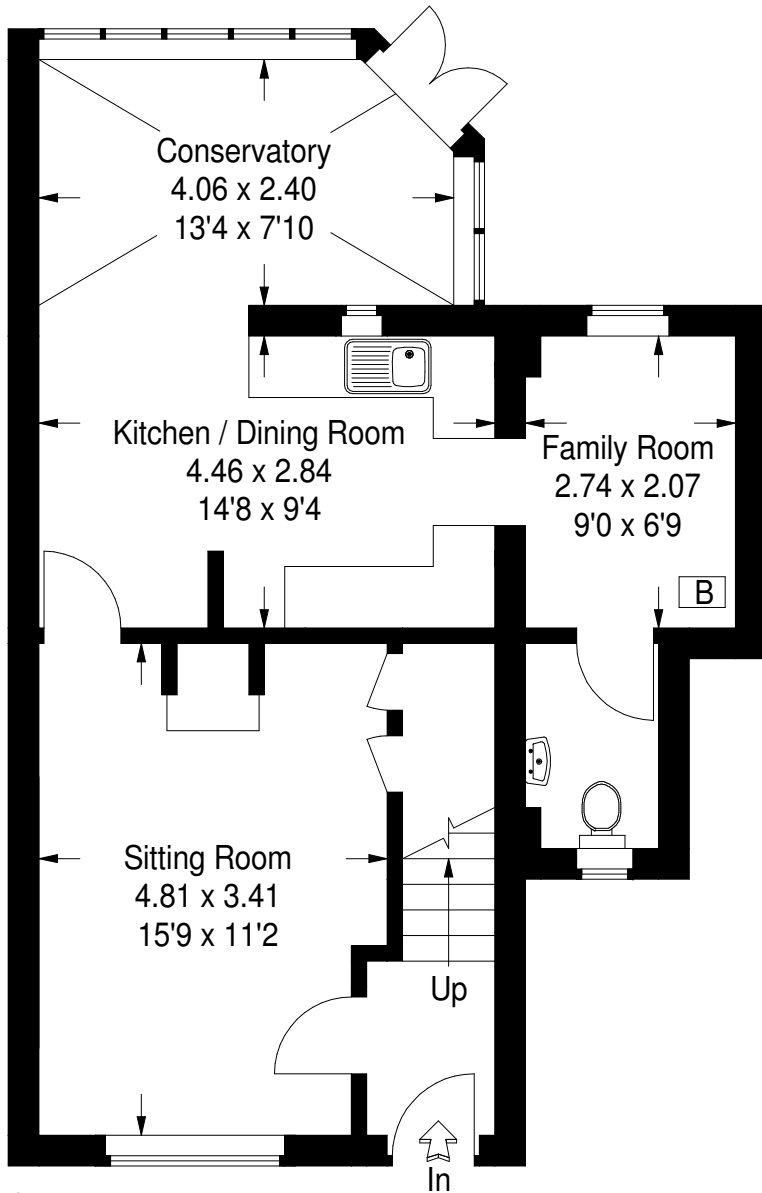
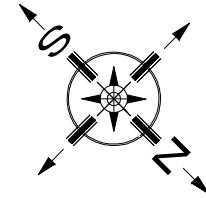

Ground Floor

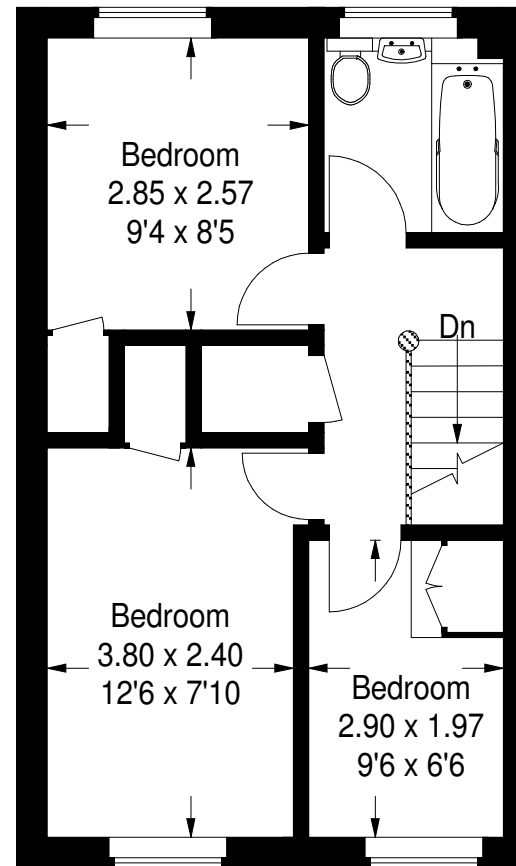

First Floor

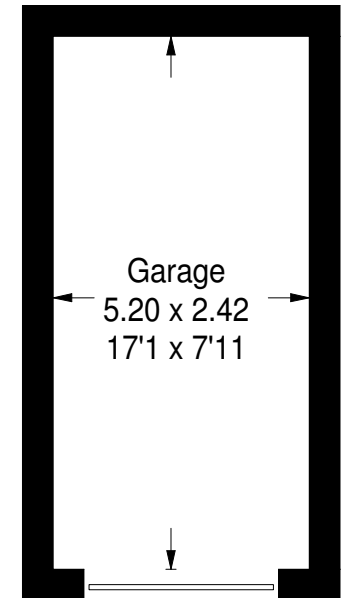

Garage

(Not Shown In Actual Location/ Orientation)

FLOORPLANZ © 2012 0845 6344080 Ref 98659

This plan is for layout guidance only. Not drawn to scale unless stated. Windows & door openings are approximate. Whilst every care is taken in the preparation of this plan, please check all dimensions, shapes & compass bearings before making any decisions reliant upon them.